

**TIMKEN****The Timken Company**

4500 Mt Pleasant St. NW

N. Canton, OH 44720

**Phone:** (234) 262-3000**E-Mail:** [CustomerCAD@timken.com](mailto:CustomerCAD@timken.com) • **Web site:** [www.timken.com](http://www.timken.com)

Part Number 7214 BTN1/CN, Timken® Single Row Angular Contact Ball Bearings (7200, 7300)

Timken® angular contact ball bearings are designed for combination radial and axial loading. Single-row bearings have high thrust capacity in one direction. Some single-row bearings are specifically designed for duplex mounting in sets for maximum performance.

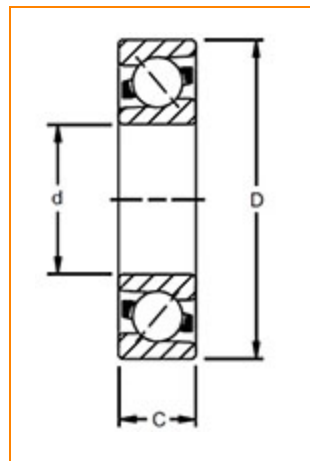

[Dimensions](#) | [Basic Load Ratings](#) | [Factors](#) | [Specifications](#) | [Abutment and Fillet Dimensions](#)

### Dimensions

|                           |                        |
|---------------------------|------------------------|
| <b>d - Bore</b>           | 70.00 mm<br>2.7559 in  |
| <b>D - Outer Diameter</b> | 125.00 mm<br>4.9213 in |
| <b>Bearing Width</b>      | 24.00 mm<br>0.9449 in  |
| <b>Contact Angle</b>      | 40 °                   |

### Basic Load Ratings



**C0 - Static Radial Rating**

58000 N  
13036 lbf

|                                       |                      |
|---------------------------------------|----------------------|
| <b>C1 ISO - Dynamic Radial Rating</b> | 69000 N<br>15509 lbf |
|---------------------------------------|----------------------|

## Factors

|                                |          |
|--------------------------------|----------|
| <b>Limiting Speed (Grease)</b> | 4900 rpm |
| <b>Limiting Speed (Oil)</b>    | 6500 rpm |

## Specifications

|                                      |                     |
|--------------------------------------|---------------------|
| <b>Ball Type</b>                     | STEEL               |
| <b>Cage Type</b>                     | Molded              |
| <b>Cage Material</b>                 | Polyamide           |
| <b>Bearing Weight</b>                | 1.11 Kg<br>2.447 lb |
| <b>Design Units</b>                  | METRIC              |
| <b>R - Inner Ring "Touch" Radius</b> | 0.6                 |
| <b>r - Outer Ring "Touch" Radius</b> | 0.6                 |
| <b>Features</b>                      | Open                |

## Abutment and Fillet Dimensions

|   |                     |
|---|---------------------|
| <b>R - Inner Ring "To Clear" Radius<sup>1</sup></b> | 1.00 mm<br>0.039 in |
| <b>r - Outer Ring "To Clear" Radius<sup>2</sup></b> | 1.00 mm<br>0.039 in |
| <b>da - Inner Ring Backing Diameter</b>             | 78.5 mm<br>3.091 in |
| <b>Da - Outer Ring Backing</b>                      | 116.5 mm            |

**Diameter**

4.587 in

- <sup>1</sup> Maximum housing fillet radius that bearing corners will clear.
- <sup>2</sup> Maximum shaft fillet radius that bearing corners will clear.

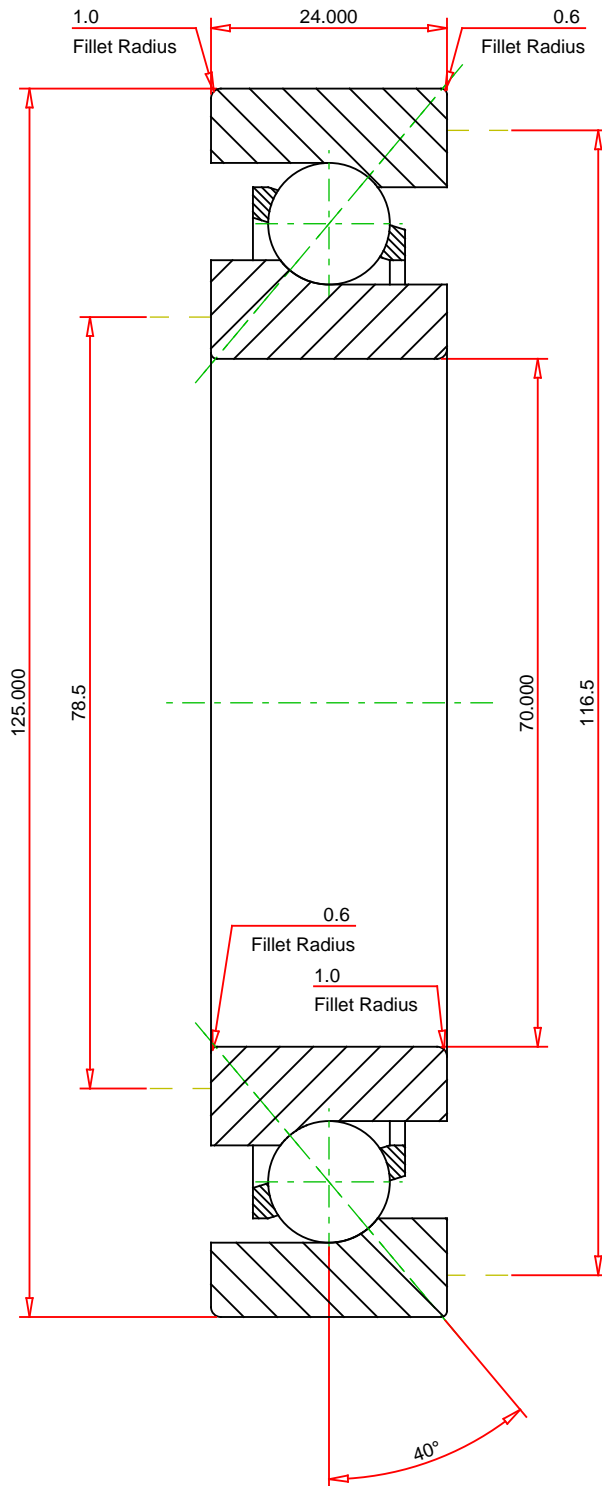

METRIC UNITS

Number of Balls Per Row 16  
 Bearing Weight 1.110 kg

**TIMKEN**®

**7214 BTN1/CN**  
 Timken® Single Row Angular Contact Ball Bearings  
 (7200, 7300)

**THE TIMKEN COMPANY**  
 NORTH CANTON, OHIO USA

Dynamic Radial Rating 69000 N  
 Static Radial Rating 58000 N

Every reasonable effort has been made to ensure the accuracy of the information contained in this writing, but no liability is accepted for errors, omissions or for any other reason.

**FOR DISCUSSION ONLY**